



**INDUSTRIAL BOLTS**

[www.dicfasteners.com](http://www.dicfasteners.com)

Product name	Page No.
Anchor Bolt .....	03 - 05
Hex Bolt .....	06 - 07
Heavy Hex Bolt .....	08 - 09
Hexagon Flange Bolt .....	10
Hanger Bolt .....	11
Head Plow Bolt .....	12
Elevator Bolt .....	12
Square Head Bolt .....	13
T-Slot Bolt .....	14
U Bolt .....	15
Eye Bolt .....	16 - 20



# ANCHOR BOLT



## Heavy Duty Anchor Bolt

Bolt Size	Bolt Length	Fixture Thickness	Hole Diameter	Minimum Hole Depth
	[mm]	[mm]	[mm]	[mm]
M6	55	10	12	50
	70	25		
	85	40		
M8	65	10	14	55
	80	25		
	95	40		
M10	75	10	16	65
	90	25		
	115	50		
	140	75		
M12	90	15	20	85
	105	25		
	120	40		
	140	60		
M16	135	15	25	125
	150	30		
	180	60		
M20	195	60	32	140
	235	100		
M24	255	100	38	160
	300	150		

Continue...



### Can Projection Anchor

Bolt Size	Bolt Length	Fixture Thickness	Hole Diameter	Minimum Hole Depth
	[mm]	[mm]	[mm]	[mm]
M6	65	10	12	50
	80	25		
	115	60		
M8	75	10	14	55
	90	25		
	125	60		
M10	90	15	16	65
	105	30		
	135	60		
M12	110	15	20	85
	125	30		
	170	75		
M16	150	15	25	125
	170	35		
	210	75		
M20	170	15	32	140
	185	30		
	255	100		
M24	255	75	38	160
	300	150		

Continue....



Bolt Size	Bolt Length	Fixture Thickness	Hole Diameter	Hook/Eye diameter
	[mm]			
M6	73	12	50	10
	83			8
M8	87	14	55	12
	98			10
M10	108	16	65	14
	120			12
M12	130	20	85	17
	145			16
M16	150	25	110	22
	175			20

- Suitable for use as a secure anchor for hanging.
- Supporting non-safety related cables.
- Supporting lighting fixtures and equipment.



# HEX BOLT

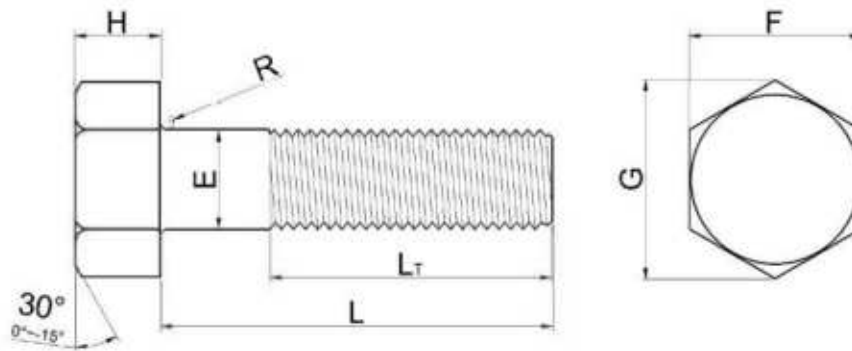

## METRIC

(UNIT : mm)

Diameter		E		H		F		G	R	L <sub>T</sub>			
Coarse	Fine	Basic	Tolerance	Basic	Tolerance	Basic	Tolerance	App	Min	1≤125	125≤200	200≤400	
M12	1.75	1.25	12	0-0.25	8	±0.30	19	0-0.8	21.9	0.6	30	36	-
M14	2	1.5	14	0-0.25	9	±0.30	22	0-0.8	25.4	0.6	34	40	-
M16	2	1.5	16	0-0.25	10	±0.30	24	0-0.8	27.7	0.6	38	44	-
M18	2.5	1.5	18	0-0.25	12	±0.35	27	0-0.8	31.2	0.6	42	48	-
M20	2.5	1.5	20	0-0.35	13	±0.35	30	0-0.8	34.6	0.8	46	52	-
M22	2.5	1.5	22	0-0.35	14	±0.35	32	0-1.0	37.0	0.8	50	56	-
M24	3	2	24	0-0.35	15	±0.35	36	0-1.0	41.6	0.8	54	60	-
M27	3	2	27	0-0.35	17	±0.35	41	0-1.0	47.3	1.0	60	66	79
M30	3.5	2	30	0-0.35	19	±0.40	46	0-1.0	53.1	1.0	66	72	85
M33	3.5	2	33	0-0.40	21	±0.40	50	0-1.0	57.7	1.0	72	78	91
M36	4	3	36	0-0.40	23	±0.40	55	0-1.2	63.5	1.0	78	84	97
M39	4	3	39	0-0.40	25	±0.40	60	0-1.2	69.3	1.0	84	90	103
M42	4.5	-	42	0-0.40	26	±0.40	65	0-1.2	75.0	1.2	90	96	109
M45	4.5	-	45	0-0.40	28	±0.40	70	0-1.2	80.8	1.2	96	102	115
M48	5	-	48	0-0.40	30	±0.40	75	0-1.2	86.5	1.6	102	108	121
M52	5	-	52	0-0.45	33	±0.50	80	0-1.2	92.4	1.6	-	116	129
M56	5.5	-	56	0-0.45	35	±0.50	85	0-1.4	98.1	2.0	-	124	137
M60	5.5	-	60	0-0.45	38	±0.50	90	0-1.4	104.0	2.0	-	132	145
M64	6	-	64	0-0.45	40	±0.50	95	0-1.4	110.0	2.0	-	140	153
M68	6	-	68	0-0.45	43	±0.50	100	0-1.4	115.0	2.0	-	148	161
M72	-	6	72	0-0.45	45	±0.50	105	0-1.4	121.0	2.0	-	156	169
M76	-	6	76	0-0.45	48	±0.50	110	0-1.4	127.0	2.0	-	164	177
M80	-	6	80	0-0.45	50	±0.50	115	0-1.4	133.0	2.0	-	172	185

Continue....

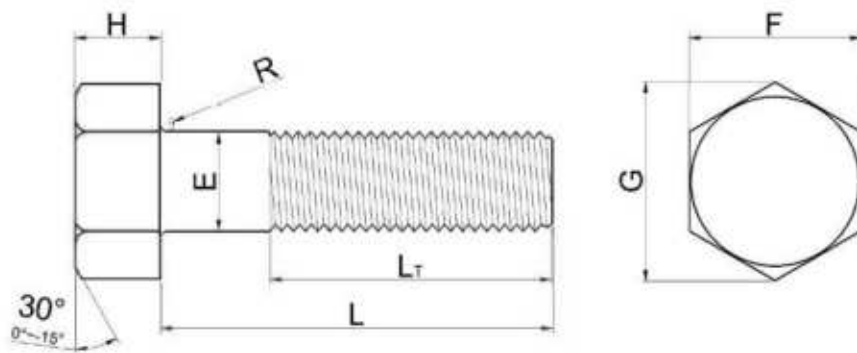

UNIFIED

(UNIT : Inch)

Nominal Size or Basic Bolt Diameter	E		F				G		H			R		L <sub>T</sub>	
	Body Dia	Max	Width Across Flats		Width Across Corners		Basic	Height		Radius of Fillet		Thread Length			
			Basic	Max	Min	Max		Min	Basic	Max	Min	Max	Min	Basic	Basic
1/2	0.500	0.515	3/4	0.750	0.725	0.866	0.826	11/32	0.364	0.302	0.03	0.01	1.250	1.500	
5/8	0.625	0.642	15/16	0.938	0.906	1.083	1.033	27/64	0.444	0.378	0.06	0.02	1.500	1.750	
3/4	0.750	0.768	1.1/8	1.125	1.088	1.299	1.240	1/2	0.524	0.455	0.06	0.02	1.750	2.000	
7/8	0.875	0.895	1.5/16	1.312	1.269	1.516	1.477	37/64	0.604	0.531	0.06	0.02	2.000	2.250	
1	1.000	1.022	1.1/2	1.500	1.450	1.732	1.653	43/64	0.700	0.591	0.09	0.03	2.250	2.500	
1.1/8	1.125	1.149	1.11/16	1.688	1.631	1.949	1.859	3/4	0.780	0.658	0.09	0.03	2.500	2.750	
1.1/4	1.250	1.277	1.7/8	1.875	1.812	2.165	2.066	27/32	0.876	0.749	0.09	0.03	2.750	3.000	
1.3/8	1.375	1.404	2.1/16	2.062	1.994	2.382	2.273	29/32	0.940	0.810	0.09	0.03	3.000	3.250	
1.1/2	1.500	1.531	2.1/4	2.250	2.175	2.598	2.480	1	1.036	0.902	0.09	0.03	3.250	3.500	
1.3/4	1.750	1.785	2.5/8	2.625	2.538	3.031	2.893	1.5/32	1.196	1.054	0.12	0.04	3.750	4.000	
2	2.000	2.039	3	3.000	2.900	3.464	3.306	1.11/32	1.388	1.175	0.12	0.04	4.250	4.500	
2.1/4	2.250	2.305	3.3/8	3.375	3.262	3.897	3.719	1.1/2	1.548	1.327	0.19	0.06	4.750	5.000	
2.1/2	2.500	2.559	3.3/4	3.750	3.625	4.330	4.133	1.21/32	1.708	1.479	0.19	0.06	5.250	5.500	
2.3/4	2.750	2.827	4.1/8	4.125	3.988	4.763	4.546	1.13/16	1.869	1.632	0.19	0.06	5.750	6.000	
3	3.000	3.081	4.1/2	4.500	4.350	5.196	4.959	2	2.060	1.815	0.19	0.06	6.250	6.500	
3.1/4	3.250	3.335	4.7/8	4.875	4.172	5.629	5.372	2.3/16	2.251	1.936	0.19	0.06	6.750	7.000	
3.1/2	3.500	3.589	5.1/4	5.250	5.075	6.062	5.786	2.5/16	2.380	2.057	0.19	0.06	7.250	7.500	
3.3/4	3.750	3.858	5.5/8	5.625	5.437	6.495	6.198	2.1/2	2.572	2.241	0.19	0.06	7.750	8.000	
4	4.000	4.111	6	6.000	5.800	6.928	6.612	2.11/16	2.764	2.424	0.19	0.06	8.250	8.500	

# HEAVY HEX BOLT

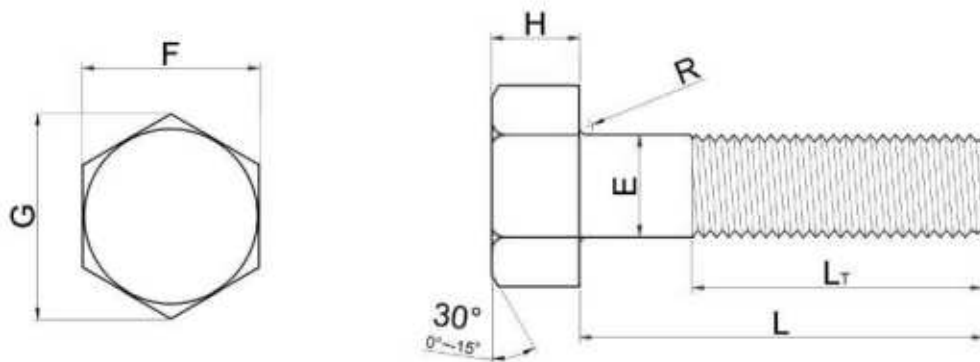

## METRIC

(UNIT : mm)

Nominal Bolt Size & Thread Pitch	E		F		G		H		R	L <sub>T</sub>		
	Body Diameter		Width Across Flats		Width Across Corners		Head Height		Radius of Fillet	Thread Length		
	Max	Min	Max	Min	Max	Min	Max	Min	Min	L ≤ 125	125 < L ≤ 200	200 < L
M12X1.75	12.70	11.30	21.00	20.16	24.25	22.78	7.95	7.24	0.6	30	36	49
M14x2	14.70	13.30	24.00	23.16	27.71	26.17	9.25	8.51	0.6	34	40	53
M16x2	16.70	15.30	27.00	26.16	31.18	29.56	10.75	9.68	0.6	38	44	57
M20x2.5	20.84	19.16	34.00	33.00	39.26	37.29	13.40	12.12	0.8	46	52	65
M24x3	24.84	23.16	41.00	40.00	47.34	45.20	15.90	14.56	0.8	54	60	73
M30x3.5	30.84	29.16	50.00	49.00	57.74	55.37	19.75	17.92	1.0	66	72	85
M36x4	37.00	35.00	60.00	58.80	69.28	66.44	23.55	21.72	2.0	78	84	97



Continue....

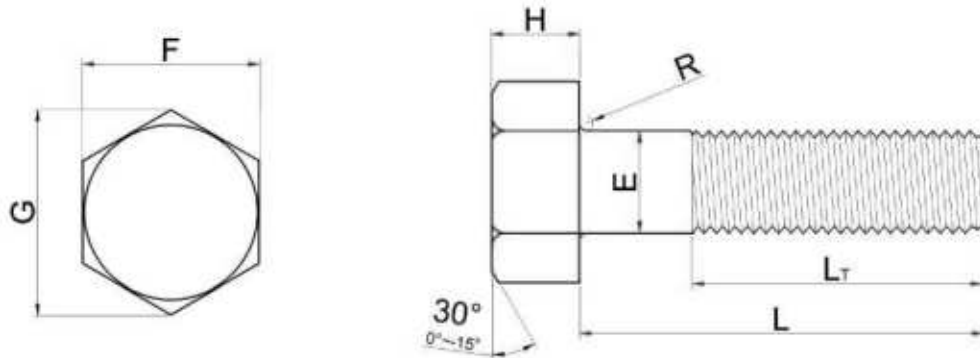

UNIFIED

(UNIT : Inch)

Nominal Size or Basic Bolt Diameter		E	F				G		H			R		L <sub>T</sub>	
		Body Dia	Width Across Flats				Width Across Corners		Height			Radius of Fillet		Thread Length	
			Max	Basic	Max	Min	Max	Min	Basic	Max	Min	Max	Min	Basic	Basic
1/2	0.500	0.515	7/8	0.875	0.850	1.010	0.969	11/32	0.364	0.302	0.03	0.01	1.250	1.500	
5/8	0.625	0.642	1.1/16	1.062	1.031	1.227	1.175	27/64	0.444	0.378	0.06	0.02	1.500	1.750	
3/4	0.750	0.768	1.1/4	1.250	1.212	1.443	1.383	1/2	0.524	0.455	0.06	0.02	1.750	2.000	
7/8	0.875	0.895	1.7/16	1.438	1.394	1.660	1.589	37/64	0.604	0.531	0.06	0.02	2.000	2.250	
1	1.000	1.022	1.5/8	1.625	1.575	1.876	1.796	43/64	0.700	0.591	0.09	0.03	2.250	2.500	
1.1/8	1.125	1.149	1.13/16	1.812	1.756	2.093	2.002	3/4	0.780	0.658	0.09	0.03	2.500	2.750	
1.1/4	1.250	1.277	2	2.000	1.938	2.309	2.209	27/32	0.876	0.749	0.09	0.03	2.750	3.000	
1.3/8	1.375	1.404	2.3/16	2.188	2.119	2.562	2.416	29/32	0.940	0.810	0.09	0.03	3.000	3.250	
1.1/2	1.500	1.531	2.3/8	2.375	2.300	2.742	2.622	1	1.036	0.902	0.09	0.03	3.250	3.500	
1.3/4	1.750	1.785	2.3/4	2.750	2.662	3.175	3.035	1.5/32	1.196	1.054	0.12	0.04	3.750	4.000	
2	2.000	2.039	3.1/8	3.125	3.025	3.608	3.449	1.11/32	1.388	1.175	0.12	0.04	4.250	4.500	
2.1/4	2.250	2.305	3.1/2	3.500	3.388	4.041	3.862	1.1/2	1.548	1.327	0.19	0.06	4.750	5.000	
2.1/2	2.500	2.559	3.7/8	3.875	3.750	4.474	4.275	1.21/32	1.708	1.479	0.19	0.06	5.250	5.500	
2.3/4	2.750	2.827	4.1/4	4.250	4.112	4.907	4.688	1.13/16	1.869	1.632	0.19	0.06	5.750	6.000	
3	3.000	3.081	4.5/8	4.625	4.475	5.340	5.102	2	2.060	1.815	0.19	0.06	6.250	6.500	

# HEXAGON FLANGE BOLTS

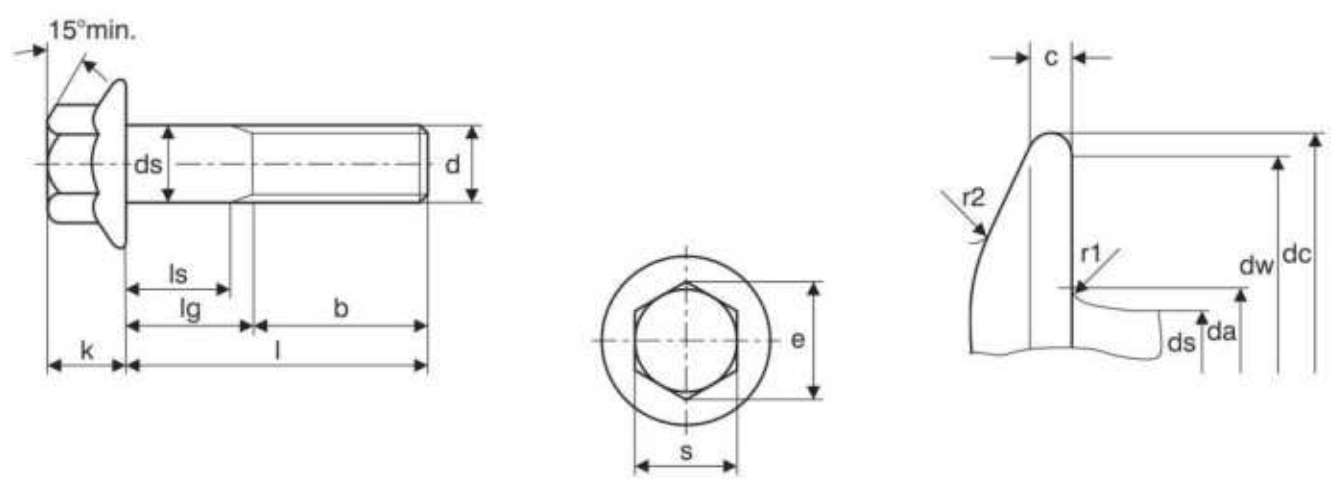

## Dimension of Bolts (DIN 6921)

High Tensile

Nominal size and thread diameter d	Pitch of thread P	Thread Length b			Depth of flange c	Transition diameter da		Diameter of flange head dc	Diameter of unthreaded shank ds		Width across corners e	Thickness of head k	Radius under head r1		r2	With across flats s	
		coarse pitch	Bolt ≤125	Bolt 125-200		Bolt ≥200	min.		nom.	max.			max.	max.		min.	min.
M5	0.80	16	-	-	1.0	5.7	6.2	11.8	5.0	4.82	8.71	5.4	0.25	0.3	8.0	7.78	
M6	1.00	18	-	-	1.1	6.8	7.4	14.2	6.0	5.82	10.95	6.6	0.4	0.4	10.0	9.78	
M8	1.25	22	28	-	1.2	9.2	10.0	18.0	8.0	7.78	14.26	8.1	0.4	0.5	13.0	12.73	
M10	1.50	26	32	45	1.5	11.2	12.6	22.3	10.0	9.78	16.50	9.2	0.4	0.6	15.0	14.73	
M12	1.75	30	36	49	1.8	13.7	15.2	26.6	12.0	11.73	17.62	11.5	0.6	0.7	16.0	15.73	
M14	2.00	34	40	53	2.1	15.7	17.7	30.5	14.0	13.73	19.86	12.8	0.6	0.9	18.0	17.73	
M16	2.00	38	44	57	2.4	17.7	20.7	35.0	16.0	15.73	23.15	14.4	0.6	1.0	21.0	20.67	
M20	2.50	46	52	65	3.0	22.4	25.7	43.0	20.0	19.67	29.87	17.1	0.8	1.2	27.0	26.67	



# HANGER BOLT

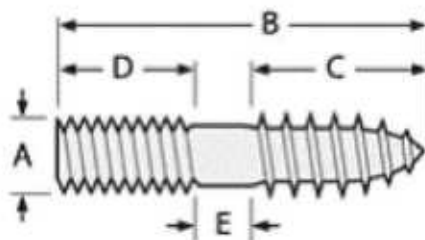

A x B	C	D	E
Size	Wood Thread Length	Machine Thread Length	Shank Length
10-24 x 1-1/2	7/8	5/8	-
10-24 x 2	1	1	-
10-24 x 2-1/2	1-1/2	1	-
10-24 x 3	1-1/2	1-1/2	-
10-24 x 3-1/2	2	1-1/2	-
1/4-20 x 1-1/2	7/8	5/8	-
1/4-20 x 1-3/4	1	3/4	-
1/4-20 x 2	1	1	-
1/4-20 x 2-1/2	1-1/2	1	-
1/4-20 x 3	1-1/2	1-1/2	-
1/4-20 x 3-1/2	2	1-1/2	-
1/4-20 x 4	2	2	-
1/4-20 x 4-1/2	3	1-1/8	3/8
1/4-20 x 5	3	1-3/8	5/8
5/16-18 x 1-1/2	7/8	5/8	-
5/16-18 x 1-3/4	1	3/4	-
5/16-18 x 2	1	1	-
5/16-18 x 2-1/2	1-1/2	1	-
5/16-18 x 3	1-1/2	1-1/2	-
5/16-18 x 3-1/2	2	1-1/2	-
5/16-18 x 4	2	2	-
5/16-18 x 4-1/2	3	1-1/8	3/8
5/16-18 x 5	3	1-3/8	5/8
5/16-18 x 6	3	1-1/2	1-1/2
3/8-16 x 2	1	1	-
3/8-16 x 2-1/2	1-1/2	1	-
3/8-16 x 3	1-1/2	1-1/2	-
3/8-16 x 3-1/2	2	1-1/2	-
3/8-16 x 4	2	2	-
3/8-16 x 4-1/2	3	1-1/8	3/8
3/8-16 x 5	3	1-3/8	5/8
3/8-16 x 5-1/2	3	1-1/2	1
3/8-16 x 6	3	1-1/4	1-3/4

# Elevator Bolt

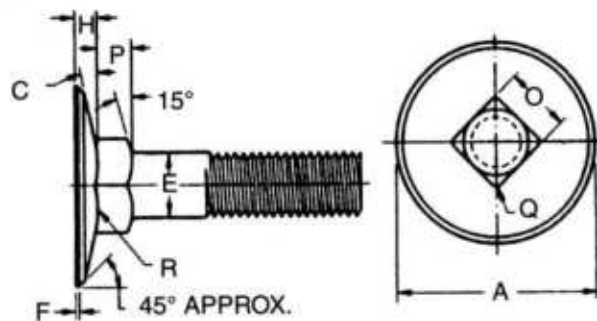

Nominal Size <sup>1</sup> or Basic Bolt Diameter	E		A			C	F	H		O		P		Q	R
	Body Diameter		Head Diameter			Head Angle	Flat on Min Dia. Head	Head Height		Square Width		Square Depth		Corner Radius On Square	Fillet Radius
			Max Edge Sharp	Min Edge Sharp	Min Edge Flat			Max	Min	Max	Min	Max	Min		
	Max	Min	Ref	Max	Max	Min	Max	Min	Max	Max					
No.10	0.199	0.182	0.790	0.750	0.740	9°	0.025	0.082	0.062	0.210	0.185	0.125	0.094	0.031	0.031
1/4	0.260	0.237	1.080	0.969	0.938	9°	0.035	0.098	0.078	0.280	0.245	0.219	0.188	0.031	0.031
5/16	0.324	0.298	1.227	1.188	1.157	9°	0.035	0.114	0.094	0.342	0.307	0.250	0.219	0.031	0.031
3/8	0.388	0.360	1.352	1.312	1.272	11°	0.040	0.145	0.125	0.405	0.368	0.250	0.219	0.047	0.031
7/16	0.452	0.421	1.477	1.438	1.397	13°	0.040	0.176	0.156	0.468	0.431	0.281	0.250	0.047	0.031
1/2	0.515	0.483	1.602	1.562	1.532	12°	0.040	0.176	0.156	0.530	0.492	0.281	0.250	0.047	0.031

# Head Plow Bolt

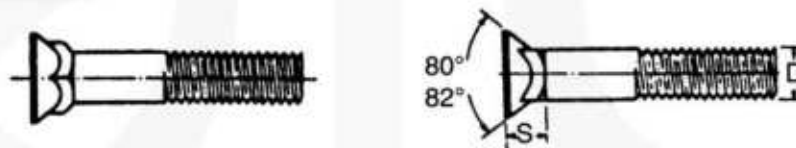

Nominal Diameter of Bolt	A			F	S		B	
	Diameter of Head			Feed Thickness	Depth of Square and Head		Width of Square	
	Max	Min Sharp	Abs. Min. With Flat	Max	Max	Min	Max	Min (Basic)
3/8	0.708	0.671	0.656	0.031	0.312	0.281	0.387	0.375
7/16	0.826	0.781	0.766	0.036	0.364	0.328	0.450	0.438
1/2	0.945	0.890	0.875	0.042	0.417	0.375	0.515	0.500
5/8	1.147	1.094	1.063	0.050	0.506	0.456	0.640	0.625



# SQUARE HEAD BOLTS

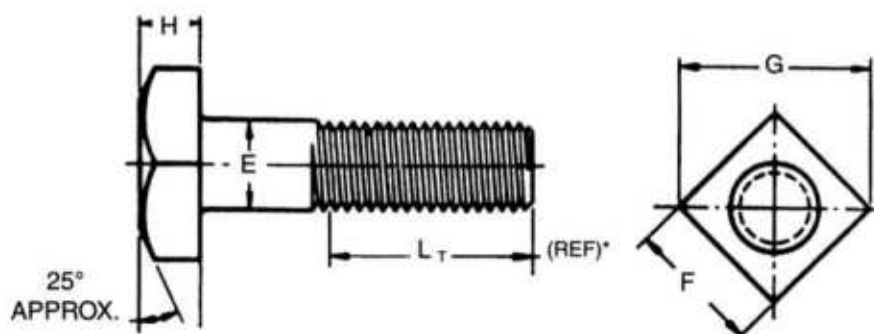

Nominal Size or Basic Bolt Dia.	E	F		G		H			L <sub>T</sub> (Ref)		
	Body Dia	Width Across Flats		Width Across Corners		Height			Thread Length For Bolt Lengths		
		Max	Basic	Max	Min	Max	Min	Basic	Max	Min	Less Than 6"
1/4	0.260	3/8	0.375	0.362	0.530	0.498	11/64	0.188	0.156	0.750	1.000
5/16	0.324	1/2	0.500	0.484	0.707	0.665	13/64	0.220	0.186	0.875	1.125
3/8	0.388	9/16	0.562	0.544	0.795	0.747	1/4	0.268	0.232	1.000	1.250
7/16	0.452	5/8	0.625	0.603	0.884	0.828	19/64	0.316	0.278	1.125	1.375
1/2	0.515	3/4	0.750	0.725	1.061	0.995	21/64	0.348	0.308	1.250	1.500
5/8	0.642	15/16	0.938	0.906	1.326	1.244	27/64	0.444	0.400	1.500	1.750
3/4	0.768	1 1/8	1.125	1.088	1.591	1.494	1/2	0.524	0.476	1.750	2.000
7/8	0.895	1 5/16	1.312	1.269	1.856	1.742	19/32	0.620	0.568	2.000	2.250
1	1.022	1 1/2	1.500	1.450	2.121	1.991	21/32	0.684	0.628	2.250	2.500
1 1/8	1.149	1 11/16	1.688	1.631	2.386	2.239	3/4	0.780	0.720	2.250	2.750
1 1/4	1.277	1 7/8	1.875	1.812	2.652	2.489	27/32	0.876	0.812	2.750	3.000
1 3/8	1.404	2 1/16	2.062	1.994	2.917	2.738	29/32	0.940	0.872	3.000	3.250
1 1/2	1.531	2 1/4	2.250	2.175	3.182	2.986	1	1.036	0.964	3.250	3.500

# T-SLOT BOLTS

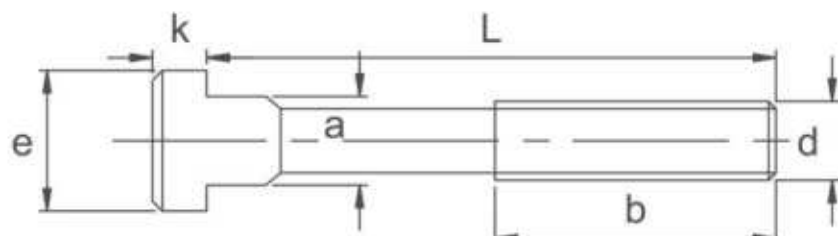

$d \times x \times L$	b	a	e	k
M6 x 6 x 25	15	5.7	10	4
M6 x 6 x 40	28	5.7	10	4
M6 x 6 x 63	40	5.7	10	4
M8 x 8 x 32	22	7.7	13	6
M8 x 8 x 50	35	7.7	13	6
M8 x 8 x 80	50	7.7	13	6
M10 x 10 x 40	30	9.7	15	6
M10 x 10 x 63	45	9.7	15	6
M10 x 10 x 100	60	9.7	15	6
M12 x 12 x 50	35	11.7	18	7
M12 x 12 x 63	40	11.7	18	7
M12 x 12 x 80	55	11.7	18	7
M12 x 12 x 125	75	11.7	18	7
M12 x 12 x 200	120	11.7	18	7
M12 x 14 x 50	35	13.7	22	8
M12 x 14 x 63	45	13.7	22	8
M12 x 14 x 80	55	13.7	22	8
M12 x 14 x 125	75	13.7	22	8
M12 x 14 x 200	120	13.7	22	8
M14 x 16 x 63	45	15.7	25	9
M14 x 16 x 100	65	15.7	25	9
M14 x 16 x 160	100	15.7	25	9
M14 x 16 x 250	150	15.7	25	9
M16 x 16 x 63	45	15.7	25	9
M16 x 16 x 80	55	15.7	25	9
M16 x 16 x 100	65	15.7	25	9
M16 x 16 x 160	100	15.7	25	9
M16 x 16 x 200	125	15.7	25	9
M16 x 16 x 250	150	15.7	25	9
M16 x 18 x 63	45	17.8	28	10
M16 x 18 x 80	55	17.7	28	10
M16 x 18 x 100	65	17.7	28	10
M16 x 18 x 160	100	17.7	28	10
M16 x 18 x 200	125	17.7	28	10
M16 x 18 x 250	150	17.7	28	10

$d \times x \times L$	b	a	e	k
M20 x 20 x 80	55	19.7	32	12
M20 x 20 x 100	65	19.7	32	12
M20 x 20 x 125	85	19.7	32	12
M20 x 20 x 160	110	19.7	32	12
M20 x 20 x 200	125	19.7	32	12
M20 x 20 x 250	150	19.7	32	12
M20 x 20 x 315	190	19.7	32	12
M20 x 22 x 80	55	21.7	35	14
M20 x 22 x 100	65	21.7	35	14
M20 x 22 x 125	85	21.7	35	14
M20 x 22 x 160	110	21.7	35	14
M20 x 22 x 200	125	21.7	35	14
M20 x 22 x 250	150	21.7	35	14
M20 x 22 x 315	190	21.7	35	14
M24 x 24 x 100	70	23.7	40	16
M24 x 24 x 125	85	23.7	40	16
M24 x 24 x 160	110	23.7	40	16
M24 x 24 x 200	125	23.7	40	16
M24 x 24 x 250	150	23.7	40	16
M24 x 24 x 315	190	23.7	40	16
M24 x 24 x 400	240	23.7	40	16
M24 x 28 x 100	70	27.7	44	18
M24 x 28 x 125	85	27.7	44	18
M24 x 28 x 160	110	27.7	44	18
M24 x 28 x 200	125	27.7	44	18
M24 x 28 x 250	150	27.7	44	18
M24 x 28 x 315	190	27.7	44	18
M24 x 28 x 400	240	27.7	44	18
M30 x 36 x 125	80	35.6	54	22
M30 x 36 x 160	110	35.6	54	22
M30 x 36 x 200	135	35.6	54	22
M30 x 36 x 250	150	35.6	54	22
M30 x 36 x 315	200	35.6	54	22
M30 x 36 x 500	300	35.6	54	22

# U - BOLT

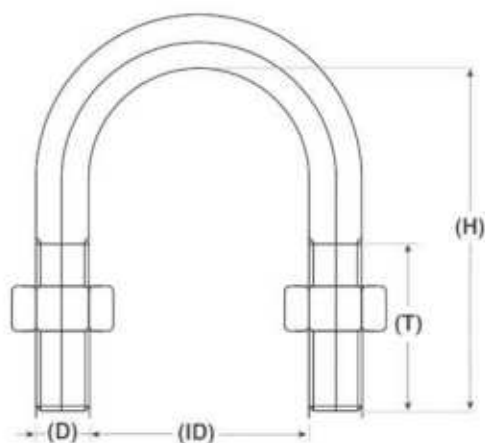

## FOR STEEL PIPING

Nominal Pipe Size		Pipe Outside Diameter	Thread Size (D)		Inner Dimension (ID)	Height (H)	Thread Length (T)
mm	inch	mm	mm	inch	mm	mm	mm
15	1/2	21.7	6	1/4	24	42	22
20	3/4	27.2	6	1/4	30	47	22
25	1"	34.0	6	1/4	36	53	25
32	1-1/4	42.7	6	1/4	46	64	28
40	1-1/2	48.6	10	3/8	52	73	30
50	2"	60.5	10	3/8	64	85	32
65	2-1/2	76.3	10	3/8	80	105	35
80	3"	89.1	10	3/8	92	118	35
90	3-1/2	101.6	12	1/2	104	131	40
100	4"	114.3	12	1/2	118	150	55
125	5"	139.8	12	1/2	144	176	55
150	6"	165.2	16	5/8	170	210	65
200	8"	216.3	16	5/8	222	262	65
250	10"	267.4	20	3/4	274	320	75
300	12"	318.5	22	7/8	326	380	90
350	14"	355.6	22	7/8	362	420	90
400	16"	406.4	22	7/8	414	470	90
450	18"	457.2	24	1"	466	530	110
500	20"	508.0	24	1"	518	585	110
550	22"	558.8	24	1"	568	640	120
600	24"	609.6	24	1"	620	690	120



# EYE BOLT

A	B	C	D	E		F	G	H
				Shoulder	Plain			
Shank Dia.	Shank Length	Eye I.D.	Eye O.D.	Overall Length		Eye Sect Dia.	Shldr. Dia.	Shldr. Thick.
0.25	1.00	0.69	1.19	2.22	2.06	0.19	0.50	0.12
	1.06	0.81		2.53	2.38	0.25	0.56	0.19
0.31	1.12	0.81	1.44	2.66	2.44	0.25	0.56	0.12
	1.19	0.94		2.97	2.75	0.31	0.62	0.19
0.38	1.25	0.94	1.69	3.09	2.81	0.31	0.62	0.12
	1.38	1.06		3.47	3.19	0.38	0.69	0.19
0.44	1.38	1.00	1.81	3.41	3.06	0.34	0.75	0.19
	1.50	1.12		3.78	3.44	0.41	0.81	0.25
0.50	1.50	1.12	2.12	3.81	3.50	0.44	0.88	0.19
	1.62	1.25		4.19	3.88	0.50	0.94	0.25
0.56	1.62	1.19	2.25	4.19	3.75	0.47	0.94	0.22
	1.75	1.31		4.56	4.12	0.53	1.00	0.28
0.62	1.75	1.31	2.56	4.56	4.19	0.56	1.00	0.25
	1.88	1.44		4.94	4.56	0.62	1.06	0.31
0.75	2.00	1.44	2.81	5.06	4.69	0.62	1.12	0.25
	2.12	1.56		5.50	5.06	0.69	1.25	0.31
0.88	2.25	1.56	3.19	5.75	5.31	0.75	1.31	0.31
	2.38	1.69		6.19	5.69	0.81	1.44	0.38
1.00	2.50	1.69	3.56	6.44	5.94	0.88	1.50	0.38
	2.62	1.81		6.88	6.31	0.94	1.62	0.44
1.12	2.75	1.94	4.06	7.31	6.69	1.00	1.69	0.44
	2.88	2.06		7.75	7.06	1.06	1.81	0.50
1.25	3.00	2.12	4.44	8.00	7.31	1.09	1.88	0.50
	3.12	2.25		8.44	7.69	1.16	2.00	0.56
1.50	3.50	2.44	5.19	9.22	8.56	1.31	2.12	0.50
	3.62	2.56		9.72	8.94	1.38	2.25	0.62
1.75	3.75	2.75	6.00	10.50	9.50	1.50	2.50	0.50
	3.88	3.00		11.12	10.12	1.62	2.62	0.62
2.00	4.00	3.06	6.88	11.53	10.56	1.75	2.88	0.62
	4.12/4.25	3.44		12.22	11.44	1.88	3.00	0.75
2.50	5.00	3.81	8.50	14.59	13.19	2.19	3.62	0.88
	5.25	4.19		15.40	14.06	2.31	3.68	1.00



Shoulder Pattern



Plain Pattern



# Continue...

<i>A</i>	<i>B</i>	<i>C</i>	<i>D</i>
Shank Dia. & Thread UNC-2A	Shank Length	Eye I.D.	Eye O.D.
1/4-20	1	3/4	1 3/16
5/16-18	1 1/8	7/8	1 7/16
3/8-16	1 1/4	1	1 21/32
3/8-16	3/4	1	1 21/32
3/8-16	5/8	1	1 21/32
7/16-14	1 3/8	1 3/32	1 27/32
1/2-13	1 1/2	1 3/16	2 1/16
1/2-13	1	1 3/16	2 1/16
9/16-12	1 5/8	1 9/32	2 9/32
5/8-11	1 3/4	1 3/8	2 1/2
5/8-11	1 1/4	1 3/8	2 1/2
3/4-10	2	1 1/2	2 13/16
3/4-10	1 1/2	1 1/2	2 13/16
3/4-10	1 1/4	1 1/2	2 13/16
7/8-9	2 1/4	1 11/16	3 1/4
1-8	2 1/2	1 13/16	3 9/16
1 1/8-7	2 3/4	2	4
1 1/4-7	3	2 3/16	4 7/16
1 1/2-6	3 1/2	2 1/2	5 3/16
1 3/4-5	3 3/4	2 7/8	6 1/16
2-4 1/2	4	3 1/4	6 7/8
2 1/2-4	5	4	8 9/16

## Shoulder Pattern

Drop Forged Carbon Steel, Self-Colored  
Fully Threaded: UNC-2A  
ASTM A489



# Continue...

<i>A</i>	<i>B</i>	<i>C</i>	<i>D</i>
Shank Dia. & Thread UNC-2A	Shank Length	Eye I.D.	Eye O.D.
1/4-20	1	3/4	1 3/16
5/16-18	1 1/8	7/8	1 7/16
3/8-16	1 1/4	1	1 21/32
7/16-14	1 3/8	1 3/32	1 27/32
1/2-13	1 1/2	1 3/16	2 1/16
9/16-12	1 5/8	1 9/32	2 9/32
5/8-11	1 3/4	1 3/8	2 1/2
3/4-10	2	1 1/2	2 13/16
7/8-9	2 1/4	1 11/16	3 1/4
1-8	2 1/2	1 13/16	3 9/16
1 1/8-7	2 3/4	2	4
1 1/4-7	3	2 3/16	4 7/16
1 1/2-6	3 1/2	2 1/2	5 3/16
1 3/4-5	3 3/4	2 7/8	6 1/16
2-4 1/2	4	3 1/4	6 7/8
2 1/2-4	5	4	8 9/16



## Plain Pattern

Drop Forged Carbon Steel, Self-Colored  
Fully Threaded: UNC-2A  
ASTM A489

<i>A</i>	<i>B</i>	<i>C</i>	<i>D</i>
Shank Dia. & Thread UNF-2A	Shank Length	Eye I.D.	Eye O.D.
1/4-28	1	3/4	1 3/16
5/16-24	1 1/8	7/8	1 7/16
3/8-24	1 1/4	1	1 21/32
7/16-20	1 3/8	1 3/32	1 27/32
1/2-20	1 1/2	1 3/16	2 1/16
9/16-18	1 5/8	1 9/32	2 9/32
5/8-18	1 3/4	1 3/8	2 1/2
3/4-16	2	1 1/2	2 13/16
7/8-14	2 1/4	1 11/16	3 1/4
1-12	2 1/2	1 13/16	3 9/16
1-14	2 1/2	1 13/16	3 9/16
1 1/4-12	3	2 3/16	4 7/16



## Fine Thread, Shoulder Pattern

# Continue...

<i>A</i>	<i>B</i>	<i>C</i>	<i>D</i>
Shank Dia. & Thread UNF-2A	Shank Length	Eye I.D.	Eye O.D.
1/4-28	1	3/4	1 3/16
5/16-24	1 1/8	7/8	1 7/16
3/8-24	1 1/4	1	1 21/32
7/16-20	1 3/8	1 3/32	1 27/32
1/2-20	1 1/2	1 3/16	2 1/16
5/8-18	1 3/4	1 3/8	2 1/2
3/4-16	2	1 1/2	2 13/16
7/8-14	2 1/4	1 11/16	3 1/4
1-14	2 1/2	1 13/16	3 9/16

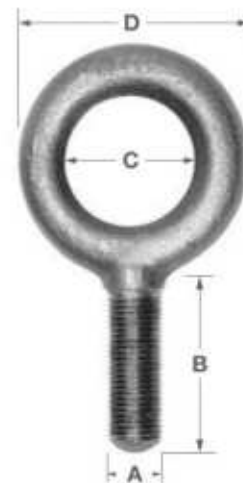

**Fine Thread, Plain Pattern**

Fully Threaded:

<i>A</i>	<i>B</i>	<i>C</i>	<i>D</i>
Shank Dia. & Thread Spec T.P.I.	Shank Length	Eye I.D.	Eye O.D.
1 1/8-8	2 3/4	2	4
1 1/4-8	3	2 3/16	4 7/16
1 3/8-6	3 1/2	2 1/2	5 3/16
1 3/8-8	3 1/2	2 1/2	5 3/16
1 1/2-8	3 1/2	2 1/2	5 3/16
1 5/8-8	3 3/4	2 7/8	6 1/16
1 3/4-8	3 3/4	2 7/8	6 1/16
1 7/8-8	4	3 1/4	6 7/8
2-8	4	3 1/4	6 7/8
2 1/2-8	5	4	8 9/16
1 3/4-8	3 3/4	2 7/8	6 1/6
2-8	4	3 1/4	6 7/8
2 1/2-8	5	4	8 9/16



**8 & 6 Threads Per Inch, Shoulder & Plain Pattern**

Fully Threaded:

Continue...



**Long Shanks  
Shoulder Pattern**  
Fully Threaded



**Long Shanks  
Plain Pattern**  
Fully Threaded

<i>A</i>	<i>B</i>	<i>C</i>	<i>D</i>
Shank Dia. & Thread UNC-2A	Shank Length	Eye I.D.	Eye O.D.
1/4-20	4	3/4	1 3/16
5/16-18	4	7/8	1 7/16
3/8-16	2 1/2	1	1 21/32
3/8-16	3	1	1 21/32
3/8-16	4	1	1 21/32
3/8-16	6	1	1 21/32
7/16-14	6	1 3/32	1 27/32
1/2-13	2 1/2	1 3/16	2 1/16
1/2-13	3	1 3/16	2 1/16
1/2-13	4	1 3/16	2 1/16
1/2-13	6	1 3/16	2 1/16
5/8-11	2 1/2	1 3/8	2 1/2
5/8-11	3	1 3/8	2 1/2
5/8-11	4	1 3/8	2 1/2
5/8-11	6	1 3/8	2 1/2
3/4-10	2 1/2	1 1/2	2 13/16
3/4-10	3	1 1/2	2 13/16
3/4-10	4	1 1/2	2 13/16
3/4-10	6	1 1/2	2 13/16
1-8	6	1 13/16	3 9/16

<i>A</i>	<i>B</i>	<i>C</i>	<i>D</i>
Shank Dia. & Thread UNC-2A	Shank Length	Eye I.D.	Eye O.D.
3/8-16	2 1/2	1	1 21/32
3/8-16	3	1	1 21/32
3/8-16	6	1	1 21/32
1/2-16	2 1/2	1 3/16	2 1/16
1/2-13	3	1 3/16	2 1/16
1/2-13	6	1 3/16	2 1/16
5/8-11	2 1/2	1 3/8	2 1/2
5/8-11	3	1 3/8	2 1/2
5/8-11	6	1 3/8	2 1/2
3/4-10	2 1/2	1 1/2	2 13/16
3/4-10	3	1 1/2	2 13/16
3/4-10	6	1 1/2	2 13/16
7/8-9	6	1 11/16	3 1/4



DIC - INDIA  
**DEDICATED IMPEX CO.**

D - 189, Industrial Focal Point, Patiala  
147003 Punjab, India  
info@dicfasteners.com  
+91-95922-28222

**DICFASTENERS**

*A Brand by Dedicated Impex Co.*